

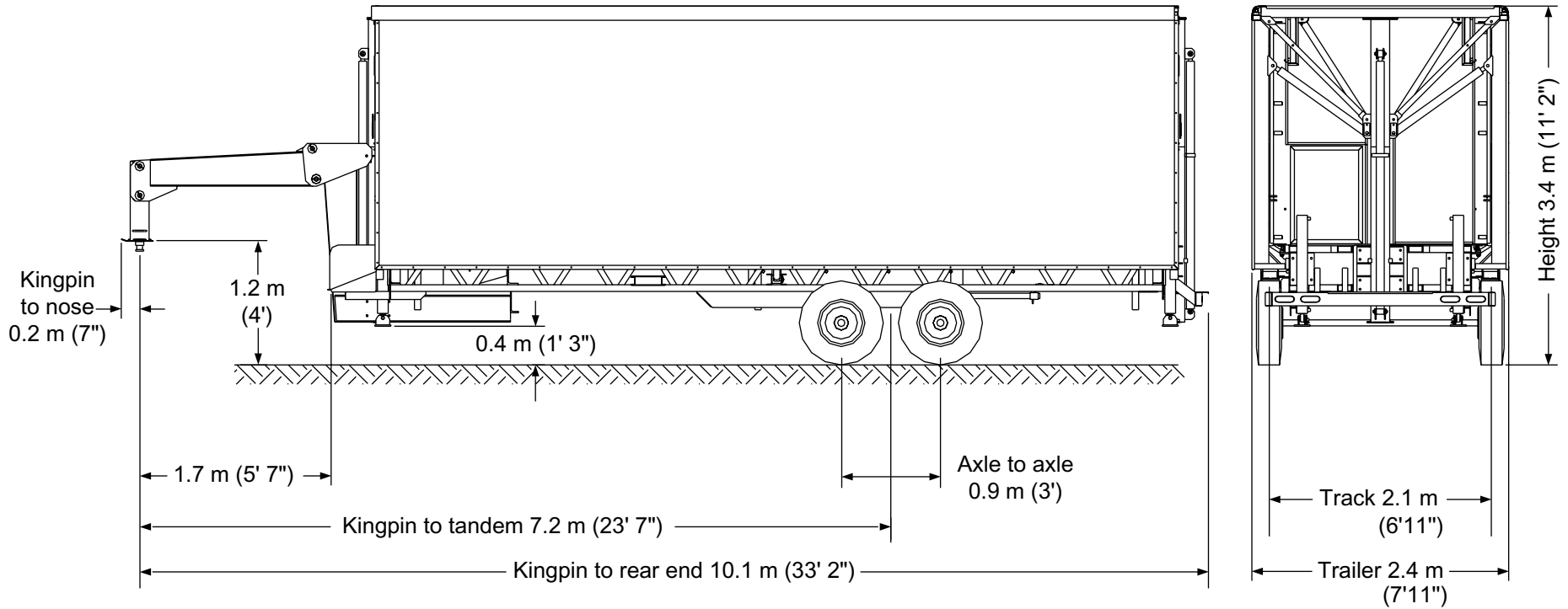

700 Marsolais Street  
 L'Assomption, Quebec  
 Canada J5W 2G9  
 Tel: (450) 589-1063  
 or 1-800-267-8243  
 Fax: (450) 589-1711  
 www.stageline.com  
 info@stageline.com

## Mass and Dimensions - SL 100



**Mass**                      **Kg**                      **Lbs**

Vehicle Mass	4540	10000
Mass on Tandem	3630	8000
Allowable Load on Axle	3100	6820

Standard: 2 axles

### Note

1. Mass may vary depending of options.



700 Marsolais Street  
L'Assomption, Quebec  
Canada J5W 2G9  
Tel: (450) 589-1063  
or 1-800-267-8243  
Fax: (450) 589-1711  
www.stageline.com  
info@stageline.com

# Stageline SL 100

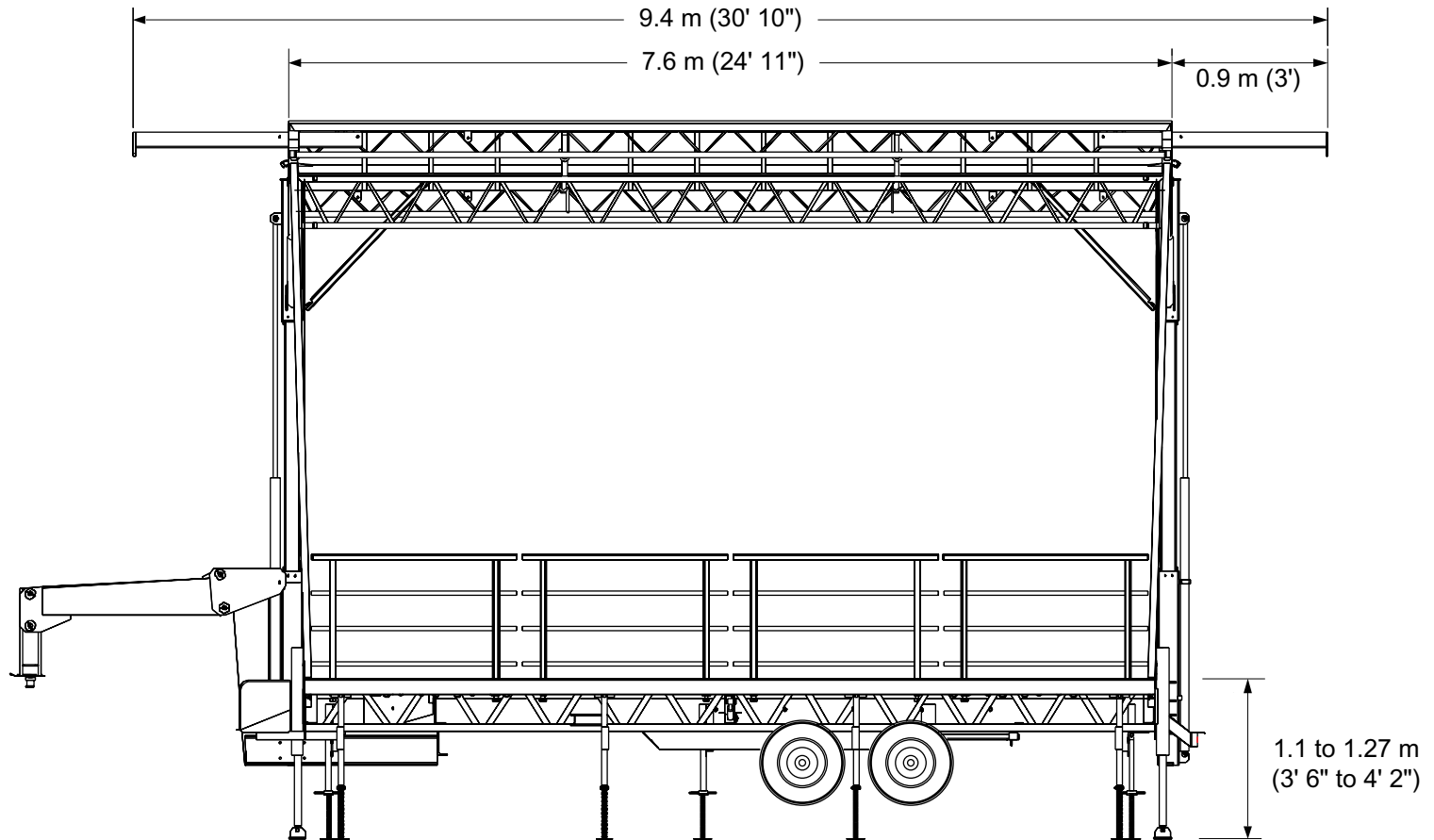

Front View

Stage specifications subject  
to change without notice  
Figures are within inch  
or cm to actual size

© 2001 - All rights reserved, Stageline Mobile Stage inc. Any and all forms of adaptation or reproduction of this document including plans and drawings found herein, in whole or in part, are strictly forbidden without the written authorisation of Stageline Mobile Stage inc.

Date: 2002-06-03  
Ref no.: D09-V-102-A  
Revision 1



700 Marsolais Street  
L'Assomption, Quebec  
Canada J5W 2G9  
Tel: (450) 589-1063  
or 1-800-267-8243  
Fax: (450) 589-1711  
www.stageline.com  
info@stageline.com

# Stageline SL 100

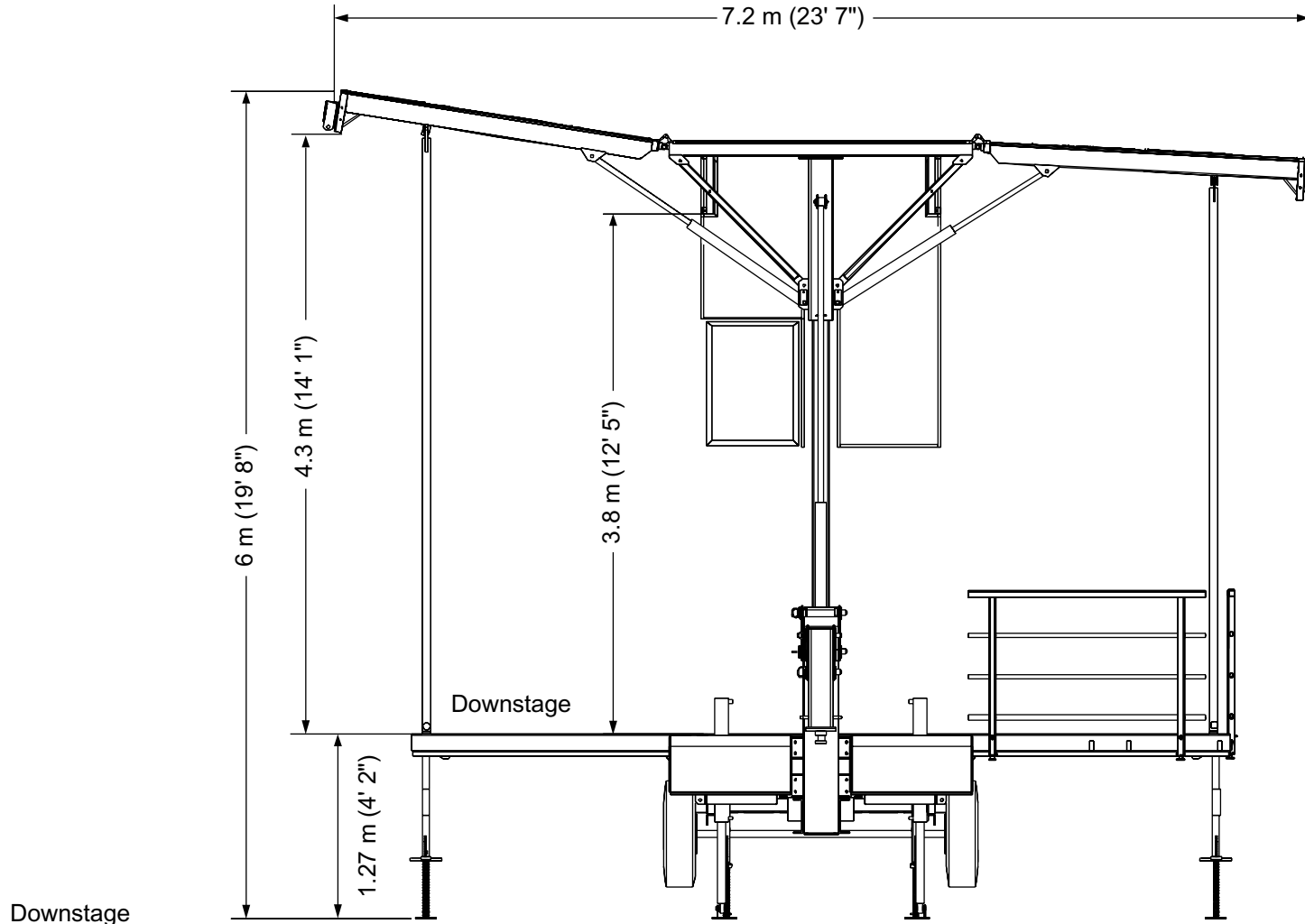

Side View

Stage specifications subject to change without notice. Figures are within inch or cm to actual size.

© 2001 - All rights reserved, Stageline Mobile Stage inc. Any and all forms of adaptation or reproduction of this document including plans and drawings found herein, in whole or in part, are strictly forbidden without the written authorisation of Stageline Mobile Stage inc.

Date: 2002-03-21  
Ref no: D09-V-101-A  
Revision 1



700 Marsolais Street  
L'Assomption, Quebec  
Canada J5W 2G9  
Tel: (450) 589-1063  
or 1-800-267-8243  
Fax: (450) 589-1711  
www.stageline.com  
info@stageline.com

# Stageline SL 100

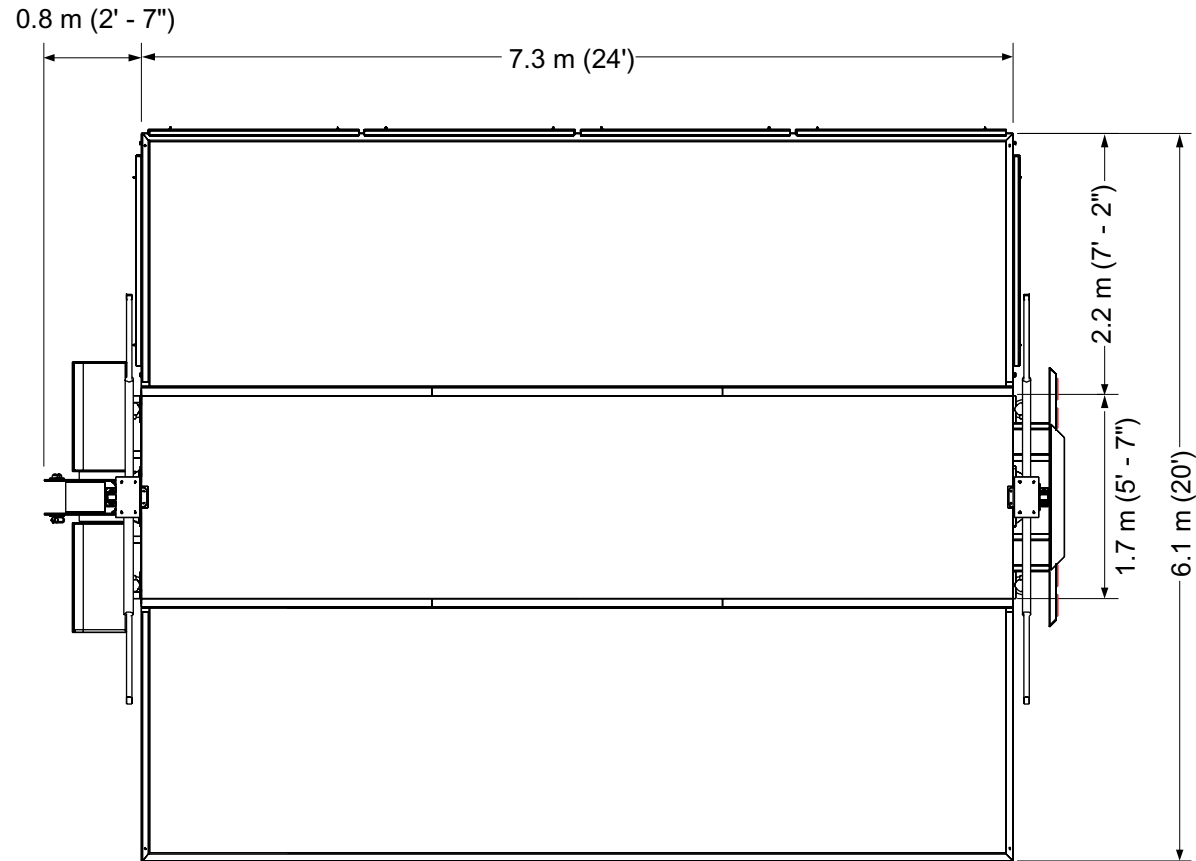

Downstage

Capacity: 100 lbs / ft<sup>2</sup> (5 kN / m<sup>2</sup>)

## Floor View

Stage specifications subject to change without notice. Figures are within inch or cm to actual size.

© 2001 - All rights reserved, Stageline Mobile Stage inc. Any and all forms of adaptation or reproduction of this document including plans and drawings found herein, in whole or in part, are strictly forbidden without the written authorisation of Stageline Mobile Stage inc.

Date: 02-03-21  
Ref. no.: D09-V-103-A  
Rev.: 1



700 Marsolais Street  
L'Assomption, Quebec  
Canada J5W 2G9  
Tel.: (450) 589-1063  
ou 1-800-267-8243  
Fax: (450) 589-1711  
www.stageline.com  
info@stageline.com

## Stageline SL 100

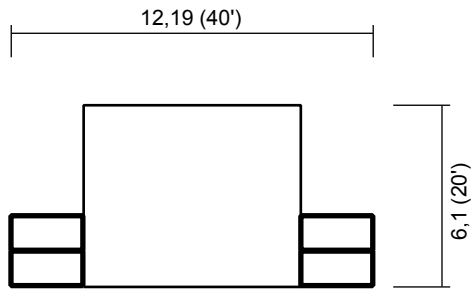

OPTION 1

12,2 x 6,1 m  
(40' x 20')

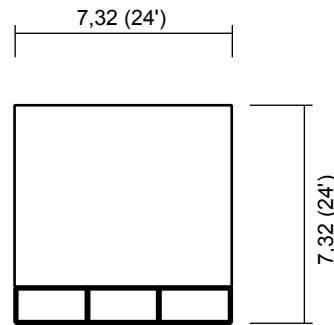

OPTION 2

7,3 x 7,3 m  
(24' x 24')

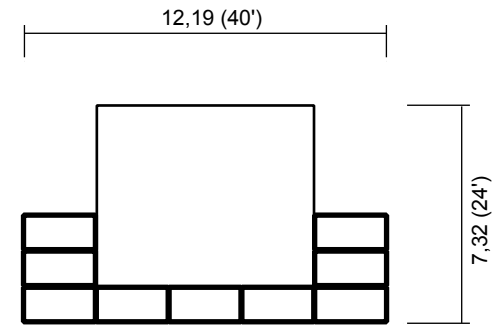

OPTION 3

12,2 x 7,3 m  
(40' x 24')

## Extension Platforms Layout



700 Marsolais Street  
L'Assomption, Quebec  
Canada J5W 2G9  
Tel: (450) 589-1063  
or 1-800-267-8243  
Fax: (450) 589-1711  
www.stageline.com  
info@stageline.com

# Stageline SL 100

## LOAD BEARING TRUSSES

TRUSS T1

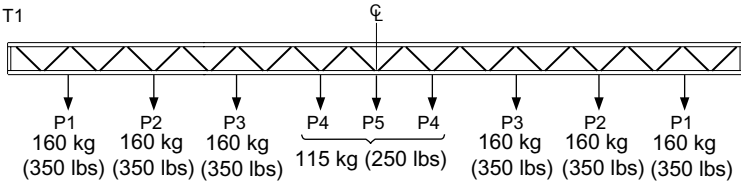

TOTAL MAXIMUM  
320 kg (700 lbs)

RIGGING PATTERNS

T1: USE P1 or P2 or P3 or P4 or P5

TRUSS T2

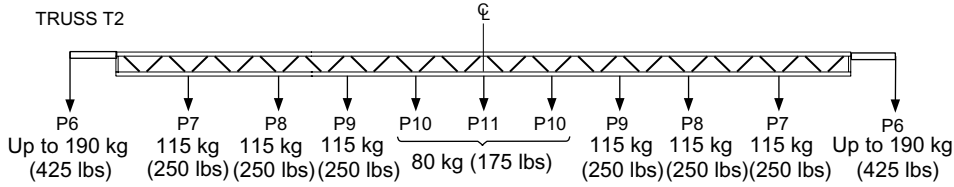

TOTAL MAXIMUM  
227 kg (500 lbs) or 380 kg (850 lbs)  
if ⓧ downstage rigging points are not used.

RIGGING PATTERNS

T2: USE P6 or P7 or P8 or P9 or P10 or P11

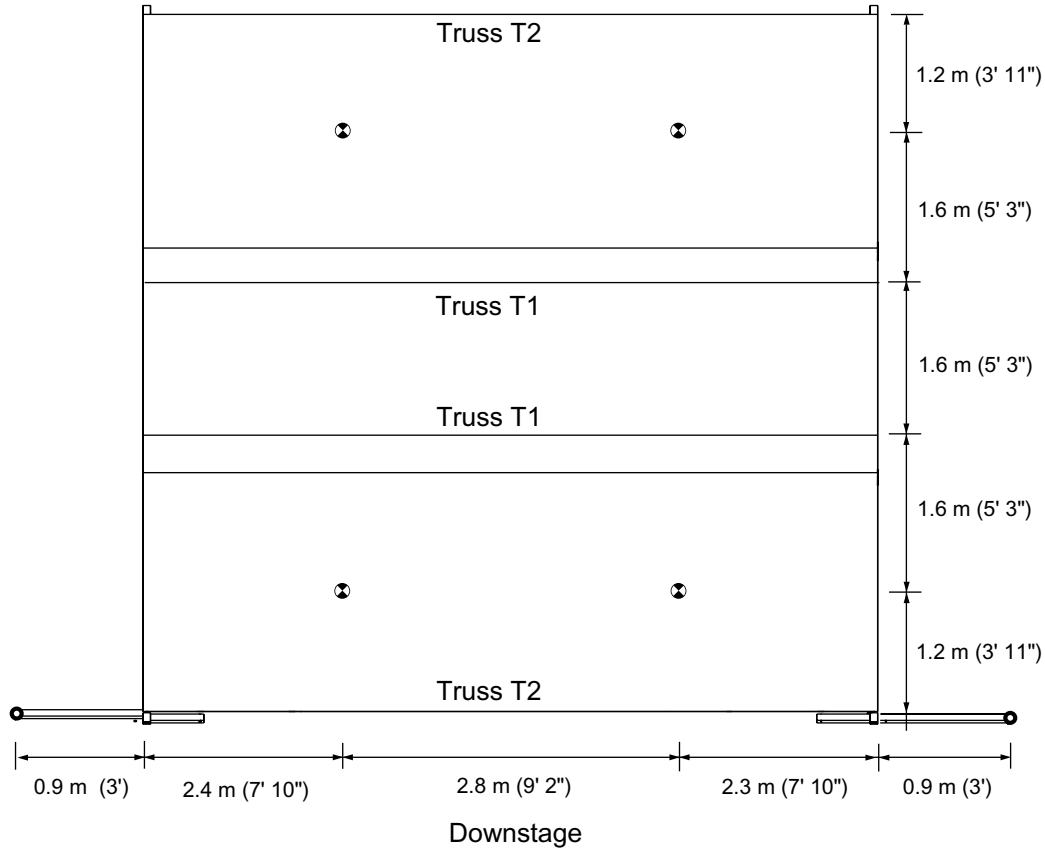

**Maximum load bearing capacity: 1725 kg (3800 lbs)**

- Rigging point maximum capacity: 190 kg (425 lbs)
- ⓧ Rigging point maximum capacity: 160 kg (350 lbs)

All loads should be evenly distributed.

## Rigging Plan



700 Marsolais Street  
 L'Assomption, Quebec  
 Canada J5W 2G9  
 Tel: (450) 589-1063  
 or 1-800-267-8243  
 Fax: (450) 589-1711  
 www.stageline.com  
 info@stageline.com

# Stageline SL 100

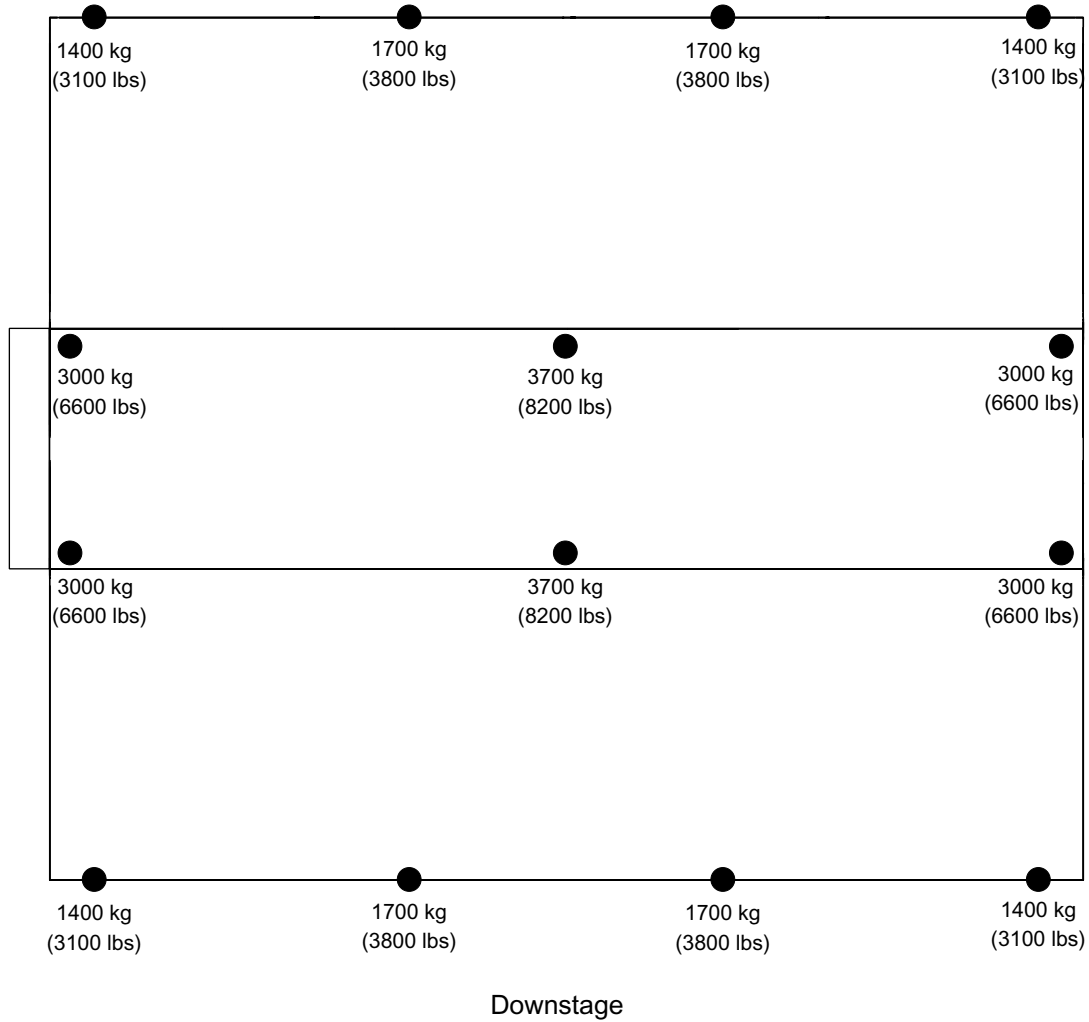

●: Floor stabilizers, extensions and levelling jacks.  
 \*Nominal specifications subject to change without notice.

## Ground Support Capacity

Figures are within inch or cm to actual size

© 2001 - All rights reserved, Stageline Mobile Stage inc. Any and all forms of adaptation or reproduction of this document including plans and drawings found herein, in whole or in part, are strictly forbidden without the written authorisation of Stageline Mobile Stage inc.

Date: 2002-06-25  
 Ref no.: D09-V-105-A  
 Revision 1

## Technical specifications

Trailer		
Length	31' 4" - 34' 9"	9.55 m - 10.59 m
Width	8'	2.4 m
Height	11' 2"	3.39 m
Storage space **	23' 6" x 5' 9" x 5' 8"	7.2 m x 1.8 m x 1.7 m
Storage Compartment	18" x 18" x 16"	0.46 x 0.45 x 0.41 m
Storage space capacity **	5,000 lb	2,268 kg
Weight	9,990 lb	4,531 kg
Stage Floor		
Length and Depth	24' x 20'	7.3 x 6.1 m
Length and Depth with Extension Platforms	40' x 24'	12.2 x 7.3 m
Height	3' 6" to 4' 3"	1.07 to 1.30 m
Design Live Load	100 lb/ft <sup>2</sup>	490 kg/m <sup>2</sup>
Type of Surface	Plywood on aluminium	
Roof		
Length and Depth	24' 11" x 23' 9"	7.59 x 7.23 m
Clearance (Inclined roof)	13' 9" to 14' 7"	4.22 to 4.45 m
Maximum Height with Banner*	23' 8"	7.21 m
Type of Surface	Fibreglass bonded on aluminium	
Roof Lifting Capacity	3,800 lb	1,725 kg
Roof Load Bearing Capacity	6,500 lb	2,948 kg
4 Built in Rigging Points	350 lb each	160 kg each
2 Trusses - Upstage and Downstage (T2)	500 lb	227 kg
2 Trusses - Central Roof (T1)	700 lb each	320 kg each
2 Front Overhang Extensions - 9' 10" (3 m)*	250 lb at 34" each	113 kg at 0.86 m each
2 Side Overhang Beams	800 lb at 36" each	363 kg at 0.9 m each
Practical Aspects		
Installation Time Once Levelling Complete	30 minutes - Less without windwall	
Personnel Required	1 Certified technician and 1 stagehand	
Site Preparation	None	



Heavy Machinery Required	None
Mode of Transportation	1 Pick-up truck or fifth-wheel tractor*
Gust Wind Resistance	60 mph (97 km/h) with windwall or 80 mph (129 km/h) without windwall
Promotional Visibility*	Rolling billboard, multiple banner options
Rigging Bars*	Retractable, can be loaded from ground or stage level
Windwall*	Weatherproof - fire retardant vinyl or scrim (blow-through material)
Vertical and Horizontal Banner Supports*	Installed at ground level, close to 340 ft <sup>2</sup> (31.6 m <sup>2</sup> ) of promotional space
Floor Extension Platforms*	Integrated brackets - easy to install